

# TO THE GREEN-LIGHT HIGHWAY HAVEN.



## VOORA, PAVING THE PATH FOR A GREAT SKYLINE.

Building beautiful homes is an art mastered by a few, but for Voora, it comes naturally. With a legacy spanning over 3 decades, the name Voora has become synonymous with excellence, setting new benchmarks in creating spaces that are not only functional but also stylish, thoughtfully designed, and built for life to flourish. From affordable homes to luxury villas and ultra-luxurious residences that epitomise sophistication, Voora has perfected the craft of building homes tailored to your unique lifestyle.

## VOORA IS ALSO A PROUD WINNER OF THE



## FEATURES THAT ELEVATE YOUR SENSES.



## PROXIMITY TO THE BEST IN LIFE.

Experience the perfect balance of serenity and convenience at Highway Haven. Located near the revered Thiruputkuzhi Divya Desam Temple, our community offers easy access to key landmarks like the Kanchipuram Bus Stand and Kanchipuram Junction for effortless travel. With corporate hubs such as Saint-Gobain and Hyundai in close proximity, business opportunities abound. Commuting is seamless with convenient access to Poonamallee Junction, Parandur Metro, and the NE 7 Express Highway. To top it off, the upcoming Parandur Greenfield Airport will bring unmatched connectivity. Embrace urban living at its finest, right here at Highway Haven.

80% BANK LOAN AVAILABLE



PROJECT APPROVED BY

Voora Group Corporate Office, No. 139, Dr. Radha Krishnan Salai, Mylapore, Chennai - 600 004, Tamil Nadu.  
Call: +91 72992 22115 | sales@voora.in | www.voora.co.in

VOORA PROPERTY DEVELOPERS PVT. LTD.

CONTACT



## A HAVEN OF TRANQUILITY AND CONNECTIVITY.

Nestled across 11.33 acres of thoughtfully-designed landscape, Highway Haven offers 269 premium plots that exemplify the harmonious blend of comfort, convenience, and natural beauty. Situated just minutes from the proposed Greenfield Airport at Parandur and the thriving industrial hub of Sriperumbudur, this exclusive community is poised to offer exceptional value and growth potential. Elegantly positioned for refined living and located on Highway NH 48, Highway Haven provides seamless connectivity while preserving the essence of serene living. Designed to promote a sense of space and serenity, each plot is placed to ensure ample natural light, ventilation, and picturesque views of landscaped greens. This is a community where tranquility and privacy are paramount, offering an idyllic setting to craft your dream home.

11.33 acres | 269 premium residential plots | Ranging from 600 - 2400 sq. ft.  
Located on Highway (NH 48).

## PERUMBULIPAKKAM, THE HIGHWAY TO A LIFE OF JOY.

Perumbulipakkam, a charming village in the Nemili Taluk of Ranipet district, Tamil Nadu, beautifully blends rural tranquility with modern convenience. Nestled near the Chennai-Bengaluru Highway (NH 48), it offers seamless connectivity while preserving the essence of traditional village life. Surrounded by lush fields and serene landscapes, Perumbulipakkam is a perfect retreat, where age-old customs and community spirit thrive amidst natural beauty. Here, the harmony of accessibility and heritage creates an idyllic lifestyle.



PLAN SHOWING THE RESIDENTIAL LAYOUT IN S.NOS 317/2 ,318/1B,319/1,2,320,321/2,322/3,325,326,327/1, OF V. NO.49. PERUMPULIPAKKAM VILLAGE, NEMILI TALUK & RANIPET DISTRICT.

SCALE 1:400  
A0 SIZE

APPROVED LAYOUT NO.LP/DTCP 51/2024

TOTAL EXTENT:- 11.33ACRE



**NOTE:-**  
Lengths in this drawing are expressed as meter(M)& Feet

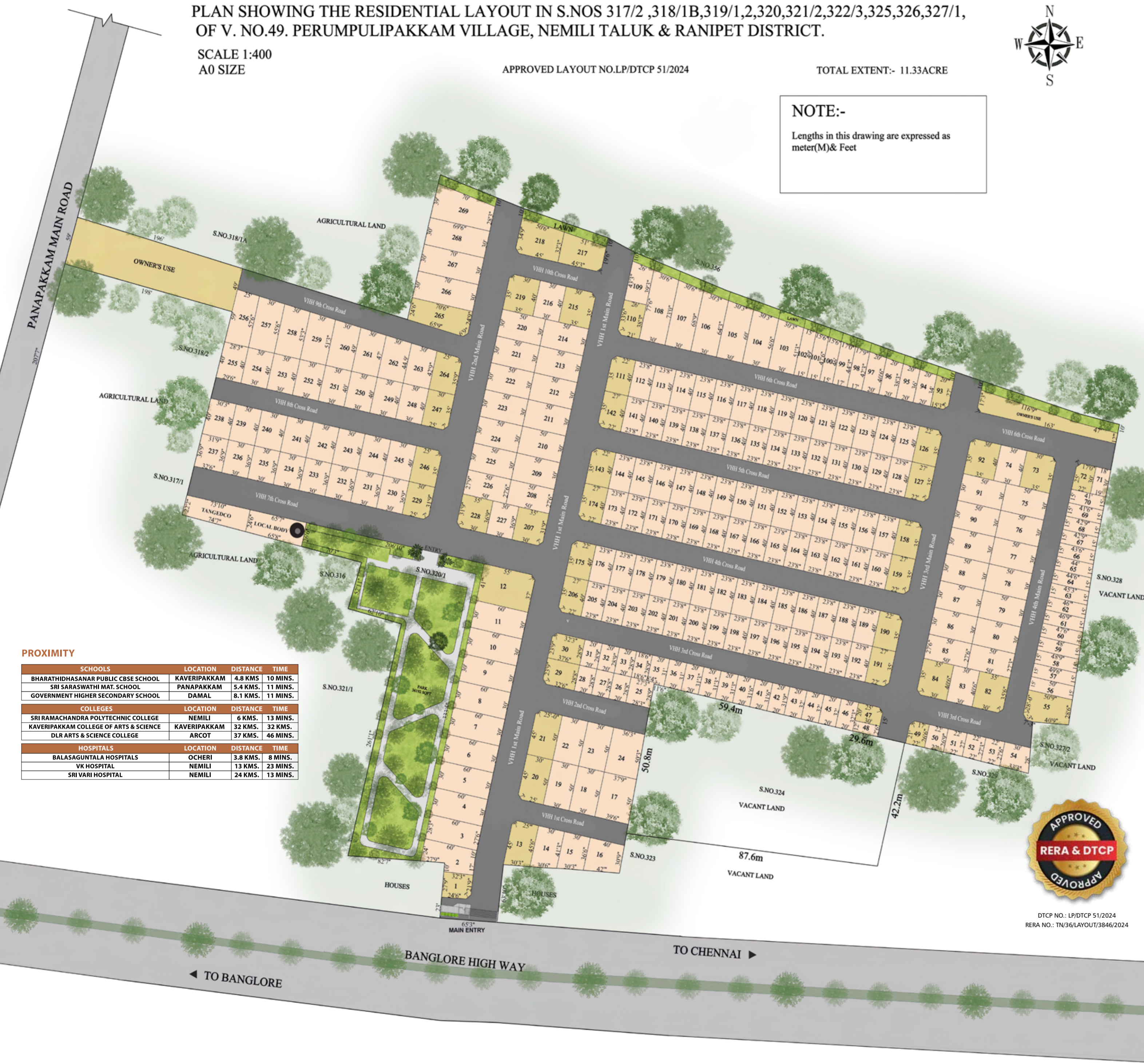

**PROXIMITY**

SCHOOLS	LOCATION	DISTANCE	TIME
BHARATHIDHASANAR PUBLIC CBSE SCHOOL	KAVERIPAKKAM	4.8 KMS	10 MINS.
SRI SARASWATHI MAT. SCHOOL	PANAPAKKAM	5.4 KMS.	11 MINS.
GOVERNMENT HIGHER SECONDARY SCHOOL	DAMAL	8.1 KMS.	11 MINS.

COLLEGES	LOCATION	DISTANCE	TIME
SRI RAMACHANDRA POLYTECHNIC COLLEGE	NEMILI	6 KMS.	13 MINS.
KAVERIPAKKAM COLLEGE OF ARTS & SCIENCE	KAVERIPAKKAM	32 KMS.	32 MINS.
DLR ARTS & SCIENCE COLLEGE	ARCOT	37 KMS.	46 MINS.

HOSPITALS	LOCATION	DISTANCE	TIME
BALASAGUNTALA HOSPITALS	OCHERI	3.8 KMS.	8 MINS.
VK HOSPITAL	NEMILI	13 KMS.	23 MINS.
SRI VARI HOSPITAL	NEMILI	24 KMS.	13 MINS.

PLOT NO.	SQ. FT.	PLOT NO.	SQ. FT.	PLOT NO.	SQ. FT.	PLOT NO.	SQ. FT.	PLOT NO.	SQ. FT.
1	829	62	696	123	947	184	947	245	1200
2	1558	63	684	124	947	185	947	246	1187
3	1673	64	673	125	947	186	947	247	1187
4	1800	65	664	126	1068	187	947	248	1200
5	1800	66	656	127	1068	188	947	249	1200
6	1800	67	647	128	947	189	947	250	1200
7	1800	68	641	129	947	190	1068	251	1200
8	1800	69	632	130	947	191	1068	252	1200
9	1800	70	619	131	947	192	947	253	1200
10	1800	71	555	132	947	193	947	254	1200
11	1800	72	648	133	947	194	947	255	1155
12	2478	73	1388	134	947	195	947	256	1551
13	1426	74	1200	135	947	196	947	257	1695
14	1312	75	1500	136	947	197	947	258	1631
15	1171	76	1500	137	947	198	947	259	1568
16	1379	77	1500	138	947	199	947	260	1504
17	1931	78	1500	139	947	200	947	261	1440
18	1500	79	1500	140	947	201	947	262	1376
19	1500	80	1500	141	947	202	947	263	1313
20	1488	81	1369	142	1068	203	947	264	1240
21	1488	82	1405	143	1068	204	947	265	1903
22	1500	83	1215	144	947	205	947	266	2108
23	1500	84	1396	145	947	206	1068	267	2100
24	1855	85	1375	146	947	207	1274	268	2093
25	797	86	1500	147	947	208	1375	269	2345
26	573	87	1500	148	947	209	1500		
27	573	88	1500	149	947	210	1500		
28	573	89	1500	150	947	211	1500		
29	1067	90	1500	151	947	212	1500		
30	1058	91	1500	152	947	213	1500		
31	575	92	1388	153	947	214	1500		
32	575	93	652	154	947	215	1388		
33	575	94	700	155	947	216	1200		
34	532	95	743	156	947	217	1424		
35	596	96	788	157	947	218	1797		
36	620	97	828	158	1067	219	1387		
37	623	98	751	159	1067	220	1500		
38	625	99	767	160	947	221	1500		
39	625	100	713	161	947	222	1500		
40	628	101	736	162	947	223	1500		
41	630	102	752	163	947	224	1500		
42	633	103	1608	164	947	225	1500		
43	638	104	1740	165	947	226	1381		
44	640	105	1872	166	947	227	1103		
45	640	106	2003	167	947	228	1274		
46	643	107	2144	168	947	229	1090		
47	588	108	2276	169	947	230	1103		
48	368	109	1073	170	947	231	1103		
49	565	110	986	171	947	232	1103		
50	586	111	1068	172	947	233	1103		
51	591	112	947	173	947	234	1103		
52	597	113	947	174	1068	235	1103		
53	602	114	947	175	1068	236	1103		
54	878	115	947	176	947	237	1181		
55	1382	116	947	177	947	238	1240		
56	756	117	947	178	947	239	1200		
57	746	118	947	179	947	240	1200		
58	737	119	947	180	947	241	1200		
59	726	120	947	181	947	242	1200		
60	716	121	947	182	947	243	1200		
61	707	122	947	183	947	244	1200		

○ REGULAR  
● CORNER



DTCP NO.: LP/DTCP 51/2024  
RERA NO.: TN/36/LAYOUT/3846/2024

**For More Details :**

**Sridhar : 98840 86958**